

Ammonia SAM

A-2024: Two methods, 4 ranges

To Set Zero

1. Press the On/Off key.
2. Press the **Mode** key to scroll to the ammonia method of choice.
 - **lr 14** = use Ammonia Vacu-vials® Kit, Catalog # K-1413, Range 0 – 3.00 ppm
 - **hr 14** = use Ammonia Vacu-vials® Kit, Catalog # K-1413, Range 0 – 60.0 ppm
 - **lr 15** = use Ammonia Vacu-vials® Kit, Catalog # K-1513, Range 0 – 10.00 ppm
 - **hr 15** = use Ammonia Vacu-vials® Kit, Catalog # K-1513, Range 0 – 150 ppm
3. Insert the ZERO ampoule (supplied in Vacu-vials® kit), flat end first, into the sample cell compartment (with mild downward pressure), making sure that it is fully seated.
4. Place the light shield over the ZERO ampoule.
5. Press the Zero/Test key. The method symbol selected in Step 2 will flash for approximately 8 seconds, then the display will show "0.0.0".

To Make a Measurement

1. Follow the range appropriate Test Procedure in the Ammonia Vacu-vials test kit of choice.
2. Insert the resulting Ammonia Vacu-vial ampoule, flat end first, into the sample cell compartment (with mild downward pressure), making sure that it is fully seated.
3. Place the light shield over the test ampoule.
4. Press the Zero/Test key. The method symbol selected above will flash for approximately 3 seconds, then the sample test result will appear in the display as ppm (mg/Liter).

Operating Tips

- Upon startup, the photometer automatically proceeds to the zeroing process. Every time the photometer powers on, it must be re-zeroed.
- To re-zero the photometer, it must be turned off and back on again.
- Upon startup, the photometer displays the last method selected.
- To switch methods, simply press the mode key. Re-zeroing is not necessary when switching methods.
- A series of readings can be taken without re-zeroing, as long as the photometer stays on during the series.
- Protect photometer from extreme humidity, corrosive fumes and dusty areas. Store in a cool, dry place.
- Remove the batteries when photometer is not in use.
- Press the ! key to turn the display back light on or off.
- When moving the photometer from one temperature extreme to another, wait at least 10 minutes before use to allow photometer to come to temperature equilibrium.
- Contamination of the optics in the sample chamber will result in incorrect measurements. The windows in the sample chamber should be checked at regular intervals and cleaned as necessary. Use a soft moist cloth or cotton swab for cleaning purposes.
- If the sample cell adapter has been removed, it must be replaced with proper orientation, aligning the triangle on the adapter with the triangle on the photometer.

Displays and Troubleshooting

E01: Light absorption too great (dirty optics)

E20/E21: Too much light reaching detector

E22 or Battery Icon: Battery should be replaced

E027, E028, or E029: Instrument zeroed incorrectly, misaligned adapter, vial not properly seated, dirty optics or failing light source.

Hi/E03: Measuring range exceeded or excessive turbidity

Lo: Test result has a negative value (less than 0 ppm)

Specifications

Auto Shutoff: After 15 minutes of non-use

Optics: 430 and 610 nm LEDs/interference filters and photosensor in transparent sample chamber

Operating Temp.: 5 to 40°C (41 to 104°F)

Battery: 4 AAA batteries (approx. 5,000 tests or 17 hours)

Waterproof: Floating, IP68 (1 hour at 0.1 meter)

Wavelength Accuracy: ± 1 nm

Photometric Accuracy: 3% full scale (T = 20 - 25° C / 68 - 77° F)

Photometric Resolution: 0.01 A

Ambient Conditions: Temperature 5 - 40° C / 41 - 104° F

Rel. humidity 30 - 90 % (non-condensing)

CE: Certificate of Declaration of CE-Conformity available upon request.

Battery Installation

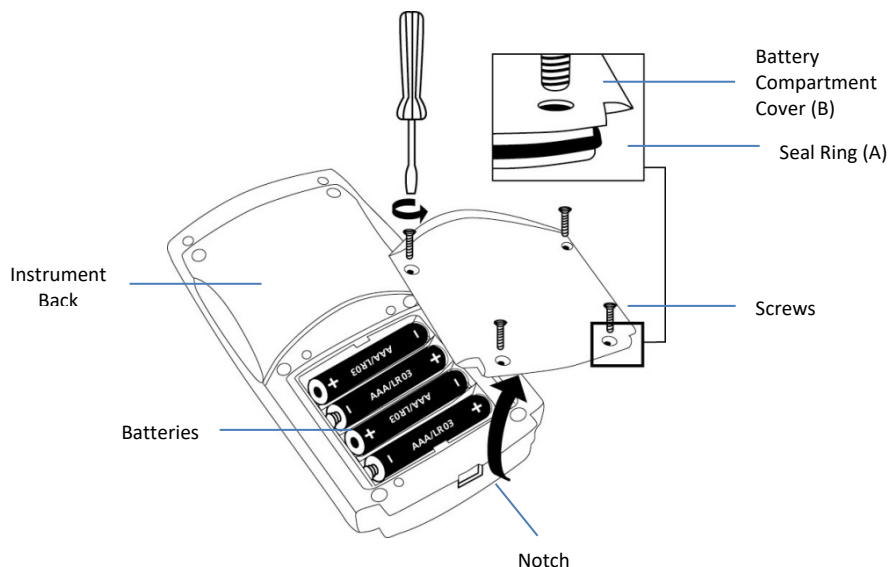

To ensure that the instrument is waterproof:

- seal ring (A) must be in position
- battery compartment cover (B) must be fixed with the four screws

Menu Selection

Setting Date and Time

Upon initial start-up, the SAM will display "Set", "dAtE", and "YYYY", then a 4 digit number. Proceed to Step 4 in the procedure below to set the date and time, or power the instrument off and on again to bypass this process. At any time that the time and/or data need to be reset, follow steps 1-6 of the procedure below.

1. Press the Mode key and hold. Turn the instrument on by pressing and releasing the Power key. Once three decimal points appear in the display, release the Mode key. The display will show "di 5".
2. Press and release the ! key until the display shows arrows in the upper right and lower left corners of the display, pointing to "Time" and "Date".
3. Press the Mode key. "Set", "dAtE" will briefly appear in the display.
4. Date and time settings are displayed in the following order: Year ("YYYY"), Month ("MM"), Day ("dd"), Hour ("hh"), Minutes ("mm"). Increase the displayed value for each setting by pressing the Mode key or decrease the value by pressing the Zero/Test key until the desired value is displayed.
5. Press the ! key to save the displayed value and to proceed to the next setting.
6. After setting the minutes, press the ! key. The display will flash "iS" "SET" and then will return to the measurement mode.

Recall of Stored Data

The SAM photometer automatically stores the last 15 data sets. To recall stored data:

1. Press the Mode key and hold. Turn the instrument on by pressing and releasing the Power key. Once three decimal points appear in the display, release the Mode key. The display will show "di 5".

Note: If the instrument is already on, press and hold the ! key for at least 4 seconds and release to access the stored data.

2. Press the Mode key. The photometer will display the stored data sets in the following format:
 - a. Sample Number: nXX (e.g. n15, n14, ... n1)
 - b. Year: XXXX (e.g. 2017)
 - c. Date: mm.dd (e.g. 03.15)
 - d. Time: hh.mm (e.g. 12:05)
 - e. Method
 - f. Result
3. Press the Zero/Test key to repeat the current data set.
4. Press the Mode key to proceed to the next data set.
5. Press the ! key to return to the measurement mode.

